

**PCN2318B MANUAL  
COMPRESSOR NEBULIZER**

Portable Aerosol Machine with 1 Reusable Nebulizer Kit & 1 Disposable Nebulizer Kit

Please read the instructions carefully before operating the product.

**1. INTRODUCTION**

The Medical Air Compressor Nebulizer System is a medical device designed to deliver medicine prescribed by a physician to the airways of the lungs. The Nebulizer Kit and the Air Compressor combined provides aerosol mist for inhalation by the patient for medical treatment only.

**2. WORK PRINCIPLE**

This unit is compact, simple to operate and convenient to carry. It uses a non-oil lubricating, single-cylinder piston pump to create air pressure.

The air flow created by the Air Compressor comes out of the jet outlet and then enters the Nebulizer Kit.

The main air flow into and out of the air compressor unit is illustrated in Figure 1.

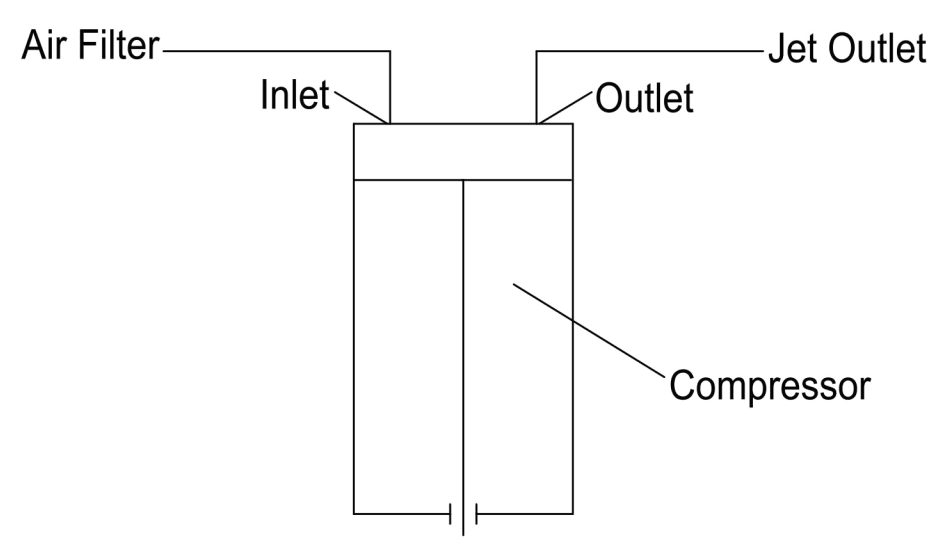

**FIGURE 1 - DIAGRAM**

**3. FEATURES**

Before using this product, make sure you have the following items:

- 1 x Main Device (Compressor)
- 1 x Disposable Aerosol Nebulizer Kit
- 1 x Reusable Aerosol Nebulizer Kit
- 1 x T-Adapter
- 1 x Reservoir Tube
- 1 x Mouthpiece
- 1 X Air Tube

**Components**

Standard nebulizer components are shown in Figure 2.

2

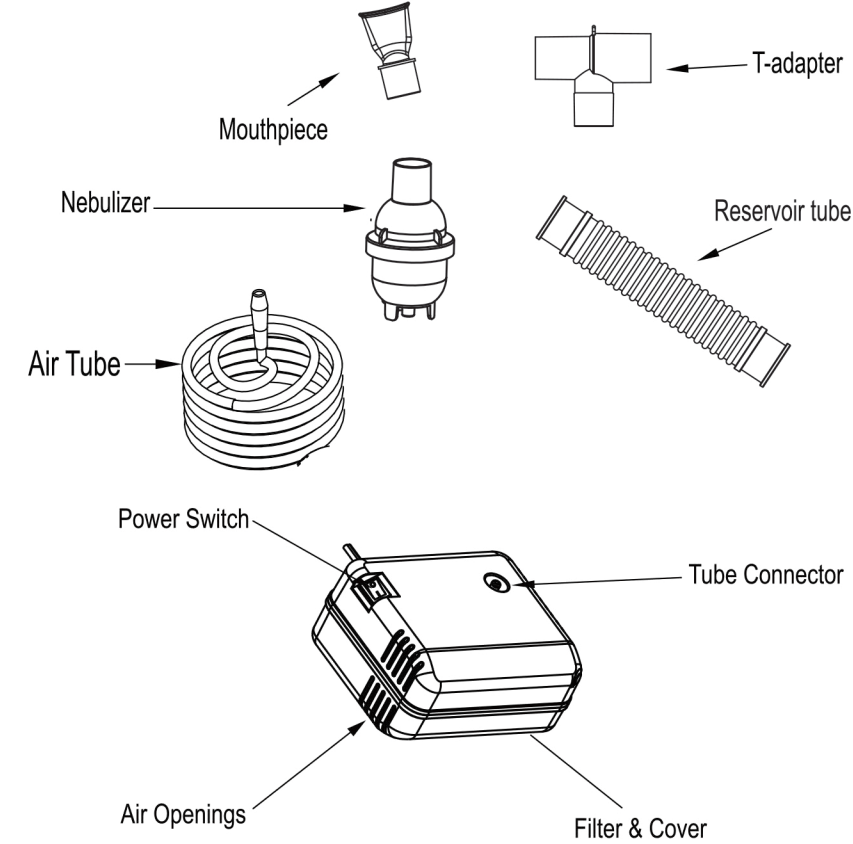

**Figure 2**

**4. FILLING MEDICINE**

To pour in medicine into the Nebulizer, do the following:

1. Open the cap (see Figure 3).
2. Fill the Medicine Container with medicine as prescribed by your physician. Ensure medicine does not exceed liquid line of 8 mL.
3. Close the cap.
4. Connect the mouthpiece. The mouthpiece is to be used for oral inhalation only.

3

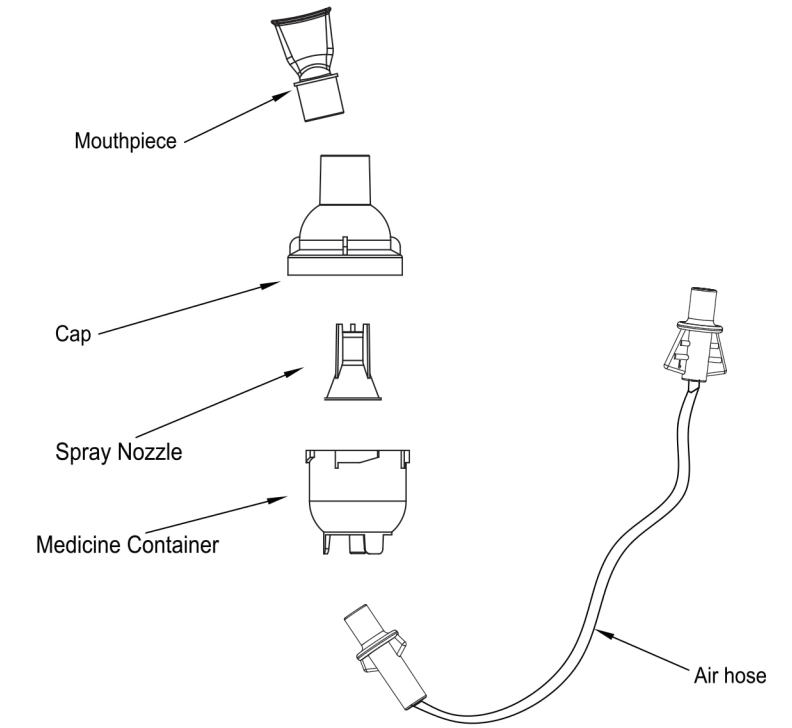

**Figure 3**

**5. OPERATION**

To operate the Nebulizer, do the following:

Plug in the Air Compressor, but do not connect the Nebulizer Kit. Make sure that the air filter is attached to the Air Compressor. Turn on the power switch. After the Air Compressor runs properly for 1-2 minutes, connect the jet outlet of the Air Compressor to the inlet of the Nebulizer Kit by the air hose. Begin treatment according to your provider's instructions. Inhale and exhale naturally. Be sure to stop when the medicine is used up.

When you have finished, turn the air compressor unit off before you disconnect the air hose.

4

**6. WARNING**

Do not use near flammable objects or locations near explosive materials.

**7. MAINTENANCE**

To keep your Nebulizer working properly, do the following after each use.

1. After you have disconnected the air hose, disconnect the mouthpiece.
  2. Open the cap and empty the Medicine Container.
- Wash the Nebulizer Kit with running water or soak in warm water for 15 minutes. For more thorough, hygienic cleaning, add some vinegar in the water. NOTE: Do not boil the Nebulizer Kit. Doing so could damage it.
3. Dry the Nebulizer Kit completely before storing it.

**8. SPECIFICATION**

Air Compressor Nebulizer Machine Features	
Power:	120VAC, 60Hz
Power Consumption:	200VA
Nebulizer Flow:	≥ 5L/min
Compressor Flow:	≥ 8 LPM
Medicine Container Capacity:	2-6 mL
Particle Size:	0.5 to 6 microns
MMAD:	2.44 microns
Average Mobilization Rate:	≥0.15 mL/min
Remain Amount:	0.15 mL
Noise Level:	below 63dBA
Compressor Pressure Range:	≥ 30 Psi /
	≥ 206 Kpa /
	≥ 2.6 bar
Operation Pressure Range:	8.0 to 13.1 Psi /
	55 to 90 Kpa /
	0.55~0.9 bar
Operating Temperature Range:	50°F to 104°F
Operation Humidity:	10% to 95%RH
Storage Temperature Range:	-4°F to 158°F
Storage Humidity Range	10% to 95%RH
Dimension (L x W x H):	160 x 136x 80mm
Product Weight:	1.46 Kg
Standard Accessories:	Compressor Nebulizer Machine
	T-adapter
	Reservoir tube
	Filter
	Air Tube 1.5m
	Medicine Cup 6 ml
	Mouthpiece

6

**9. TROUBLESHOOTING GUIDE**

Symptom	Probable Cause	Solution
Noisy	No filter in the unit.	Put a filter in the unit.
The Nebulizer does not run.	Main compressor switch is off.	Turn the unit on.
	Nebulizer was not cleaned after its previous use.	Clean the unit.
	Air hose is bent.	Remove any bend or kink in the air hose.
	The filter is clogged.	Replace the filter.
	No medicine is left.	Add the appropriate amount of medicine prescribed by your provider to the Medicine Container.
	The cap is not attached properly.	Reattach the cap.
Water Drops are formed in the air hose.	The medicine was over-full.	Adjust the amount of medicine in the Medicine Container to the appropriate level, connect the air hose to the Air Compressor, and turn the unit on.
	The Nebulizer Kit was washed but not dried.	Open and close the Nebulizer Kit repeatedly until the drops disappear.

NOTE: Please contact your provider for assistance in case you have any other difficulties.

7

**3 YEAR LIMITED WARRANTY**

Your compressor is warranted to be free from defects in material, and workmanship for a period of 3 years from the date of purchase. The warranty covers only the compressor. The replaceable components like nebulizer, mouthpiece, air hose, and filters are not included. Opening or altering the device invalidates the warranty. The warranty does not cover damage caused by improper handling, accidents, or non-compliance with operating instructions.

Rhythm Healthcare, LLC

contactus@rhythmhc.com

www.rhythmhc.com

(877) 843-6464

5